

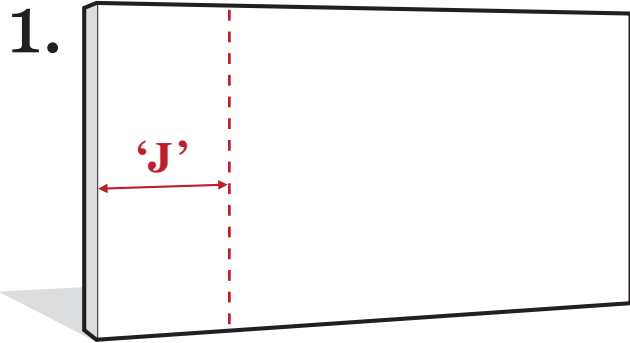

INSTALLATION GUIDE

JW Tuffwall & JW Standard

Your 'J' length is _____ mm



1. From the far left edge of your wall measure your "J" length given above

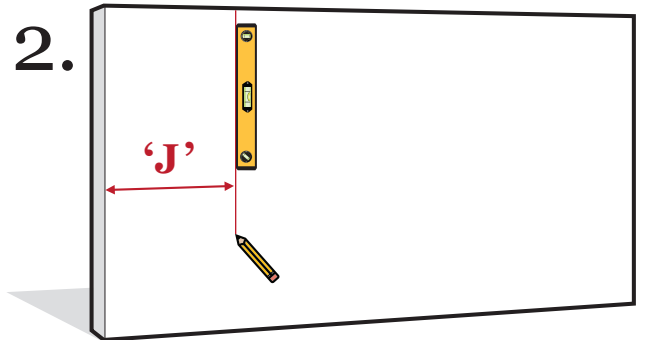

2. Draw a straight line using a spirit level or plumb line

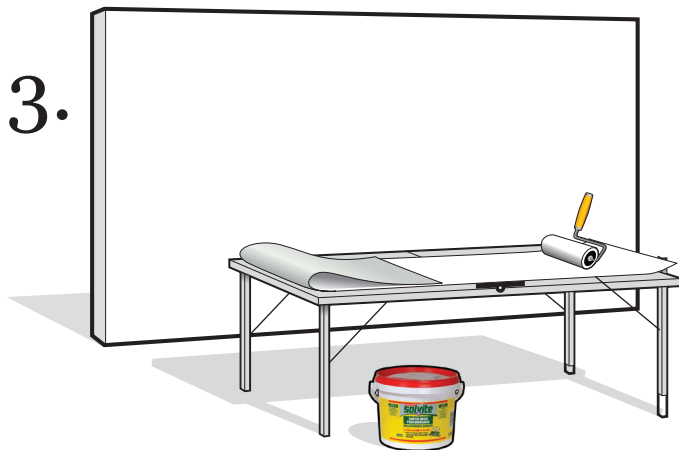

3. Apply paste to reverse DROP A. Use a strong adhesive (such as Solvite Super Strength) and paste right to the edges. Take care not to miss any areas.

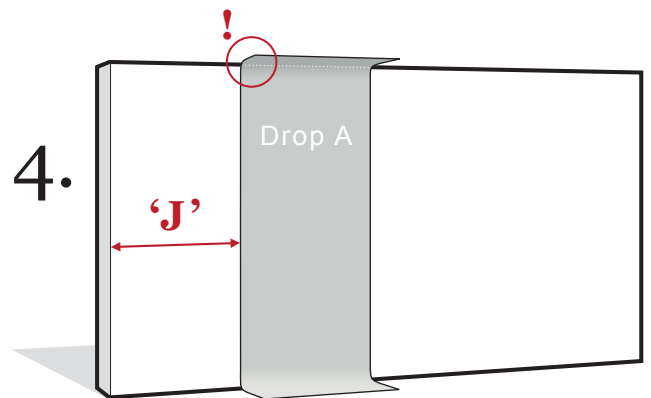

4. Line the left hand edge of DROP A to the line you have drawn. Use the faint positioning marks to line up the top of your drop to the top of your wall. Remember you have overlaps, do not trim them yet. Take time to make sure everything is smoothed properly into place and that all edges are stuck down.

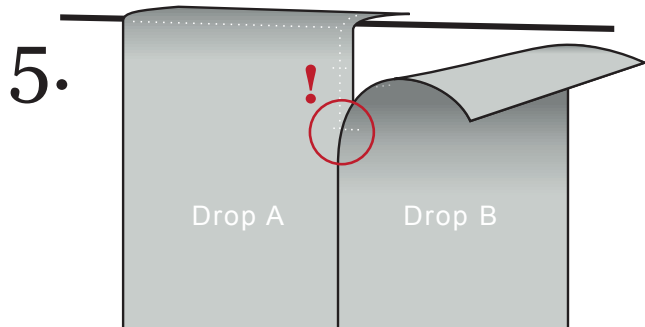

5. Paste and position DROP B. Use the faint positioning marks on the edge of DROP A to position the left edge. Don't trim yet! Take special care to make sure there is plenty of paste on your overlaps.

6.

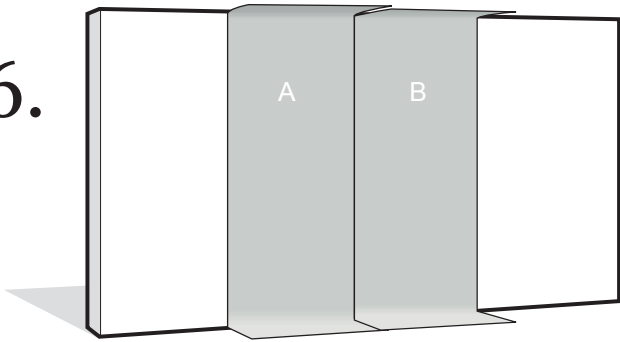

7.

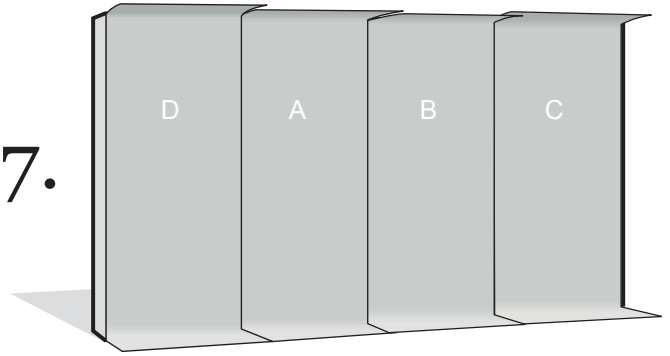

Repeat the process. Place each drop in order (You will have overlaps all around).

8a.

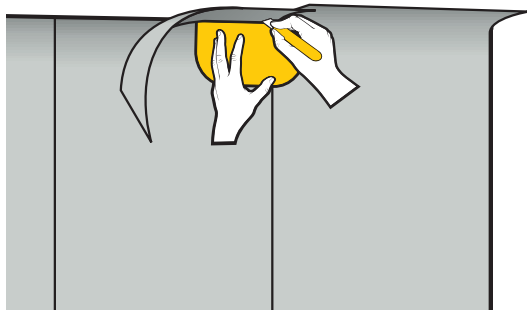

Trim! Using a very sharp knife and your smoother to guide you, push into the corners and out SLOWLY along the edges.

8b.

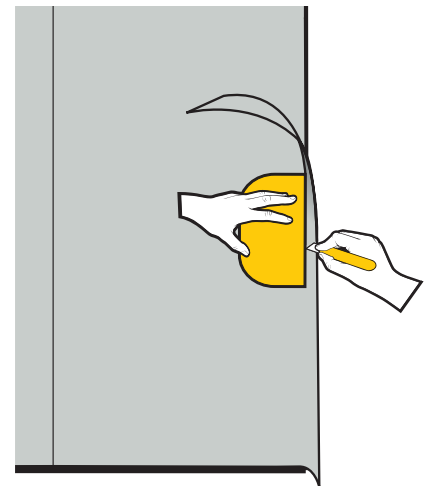

9a.



TRIMMING THE OVERLAP
Splice your sections. Make a clean, straight, vertical cut through BOTH layers at the centre of the overlaps.

b.

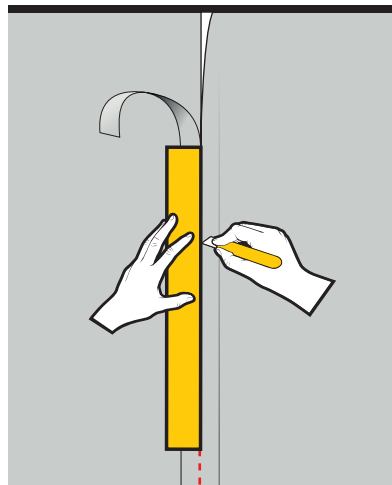

Peel away the waste on the top layer

c.

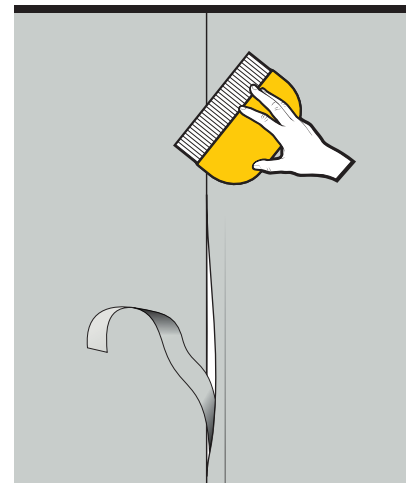

Lift the overlap and peel away the waste on the bottom layer. Smooth both layers back down.

10.

